



nepolite™

lite hai to right hai...



for smooth & silky surfaces

nepogyp™

premium quality gypsum powder

Nepolite™

Nepolite Concrete Solutions Pvt. Ltd. is a brand founded to produce, manufacture, sell and propagate eco-friendly and quality products and materials that are adaptable, complete and seamless alternatives for traditional, obsolete and hazardous products and materials being extensively used in the Construction Industry across India.

Nepolite™ aims to propagate the use of newer technologies coupled with greener materials hitherto unknown and unacceptable to the Indian Construction Industry and all the key personnel involved in it.

Nepogyp™

As one out of the many newer products lined up in its array, **Nepolite™**, in its aforesaid endeavour, introduces **Nepogyp™**, a premium quality gypsum powder to be used in the internal plastering process of building constructions.

Nepogyp™ is a 100% Gypsum based product.

Gypsum has been traditionally used for internal plastering and decorative works of buildings in various parts of the world since centuries.

Gypsum is either mined in its raw form or is synthetically manufactured in a factory. After undergoing various rigid processes during its manufacturing and after the addition of required additives it is packed in easy to use and handle, 5 and 25 KG bags.

The natural colour of Gypsum is off-white or white. It has an excellent bonding strength and is fine and powder like in appearance.

Gypsum is an eco-friendly product, as the mining or the manufacturing of synthetic Gypsum does not harm the ecology or the environment of our habitat in any way.

Nepogyp™ VS Sand and Cement Mortar

Gypsum is an excellent substitute to the conventional sand and cement based mortars used for plastering internal walls and other RCC surfaces of a building.

Nepogyp™ is used to plaster all type of old and new internal walls and RCC surfaces such as columns, beams, partition walls, slabs, etc. **Nepogyp™** can be applied directly on all of these surfaces.

Nepogyp™ needs negligible amount of water for initial preparation and needs no curing at all. Traditional plastering with sand and cement mortar needs tremendous amount of water for initial preparation and for curing the surfaces post plastering. Freshly plastered surfaces need to be cured with water in order to gain and achieve the desired strength. The curing process involves extensive usage of scarce and valuable resources such as water, electricity for pumping, and human labour.

Nepogyp™ needs no sand. Regular plastering with sand and cement mortars needs sand. Sand in India is usually mined from the river basins. Recent studies by prominent environmentalists show that removing sand from the river basins is a major reason for rivers drying up.

Nepogyp™, once applied, achieves its final setting and strength in a short period of time. This means that a wall plastered using **Nepogyp™** is ready for painting and finishing sooner, thus saving a lot of time. The walls plastered with regular sand and cement based mortar take more time to be ready for painting and finishing as these walls need to be moisture free (completely dry).

Nepogyp™, manufactured using stringent quality control procedures and under skilled supervision rules out the possibility of any impurity entering into the product which ensures that the surfaces do not develop any cracks, which in turn increase the quality and life of the construction. Conventional plastering made up of sand and cement mortars can develop cracks on the surfaces because of the presence of silt and other impurities in sand.

Nepogyp™ can be used for repairs and maintenance works with tremendous ease without giving rise to the chance of defective bonding between new and old surfaces and preventing the formation of cracks due to such non-bonding between surfaces.

Nepogyp™ Features

- Can be applied to all surfaces directly
- Results in a smooth finish
- Ideal for repairs and remodelling work
- Delivers a strong substrate for putty and paints
- For interior use only
- Initial setting time 8 - 20 minutes

Why Nepogyp™?



eco
friendly



smooth
& silky



super
strong



thermally
insular



Nepogyp™ Compatibility

Nepogyp™ can be applied directly on all the surfaces shown below



Brick Wall



Cement Block Wall



Concrete Wall

Application Method

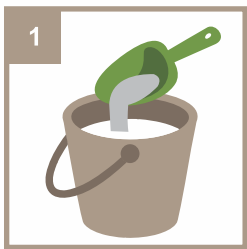

1 Mix powder in water (in the ratio of 2:1) and not vice versa

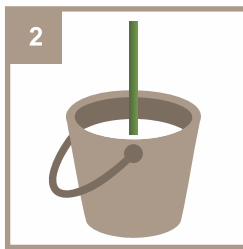

2 Mix thoroughly to create an uniform, smooth and lump free paste

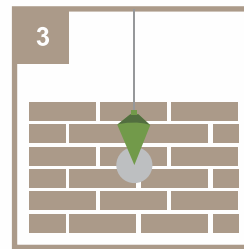

3 Put bull marks at every 4 ft. and ensure all levels using plumb

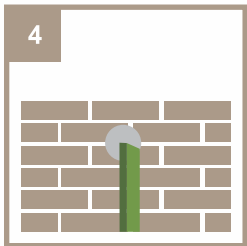

4 By putting aluminum box plate (bottom patti) on the bull marks, fill the gap with nepogyp™ plaster

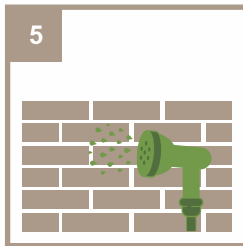

5 Pre-wet the background

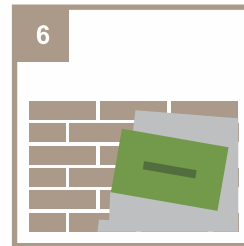

6 Apply fresh material paste on the wall with the help of a trowel

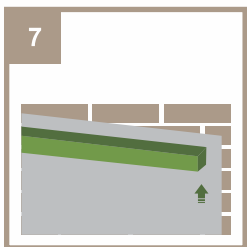

7 Level the material paste on the wall with the help of aluminum box plate (bottom patti)

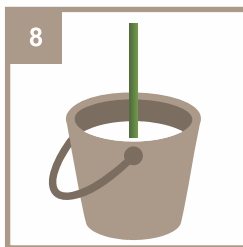

8 Mix the powder to create a thin and uniform slurry

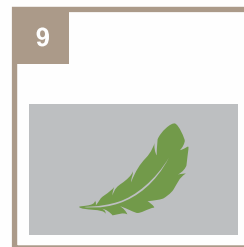

9 Apply on leveled surfaces with a trowel to get a smooth and silky finished surface



nepolite™

lite hai to right hai...

Dealer Details:

Nepolite Concrete Solutions Pvt. Ltd.

☎ 8308310300

e-mail - info@nepolite.com | www.nepolite.com